

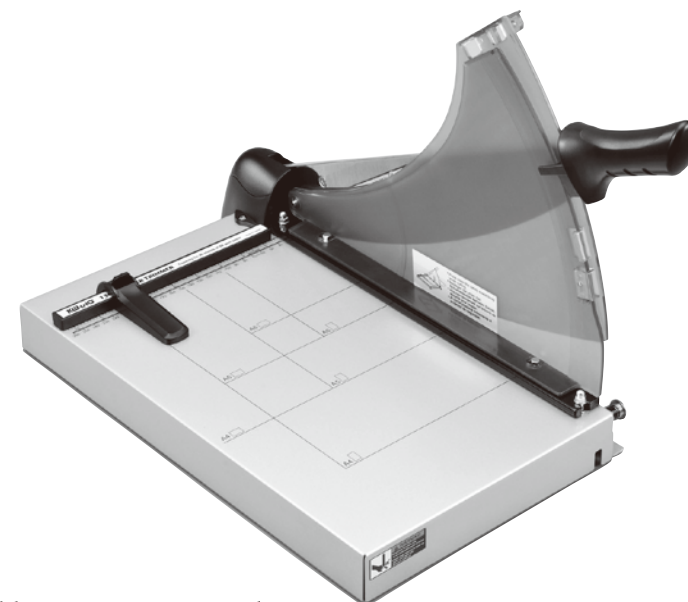

Care and Maintenance

CAUTION: To avoid damaging the product, never immerse the product in water or other liquids.

Do not use abrasive cleaners on the product. Dust with a soft cloth using extreme caution around the blade.



Paper Guillotine With Automatic Paper Clamping System



Instruction Manual



BEFORE USING THIS PRODUCT, READ, UNDERSTAND, AND FOLLOW THESE INSTRUCTIONS.

FOR INDOOR USE ONLY

IMPORTANT SAFEGUARDS

- **Read all instructions before using.**
- This product is not intended for use by children. Keep product out of the reach of children and pets.
- This product is intended for use in trimming paper. Do not use the product for any other purpose.
- Keep loose items (e.g., hands, fingers, jewelry, clothing, neckties, etc.) away from the blade to avoid personal injury or damage to the product.
-  To avoid damage to the product
 - Remove paper clips and staples from items before trimming paper.
 - Never lubricate the cutting blade.
 - Do not expose product to water or other liquids.
-  To avoid possible severe personal injury
 - Never operate the trimmer without the safety shield in place
 - Never carry the trimmer by the blade.
 - Never carry the trimmer by the cutting handle.
 - Always ensure the blade lock is secure when the product is not in use.
- Do not attempt to dislodge jammed debris with a pointed object, as personal injury or product damage may occur.
- Always operate the product on a flat, level, steady surface to avoid it overturning.
- Do not hang or wall-mount the product.
- This product is intended for indoor use only. Do not use outdoors.

Components description

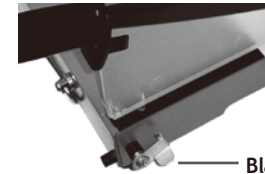

Blade lock

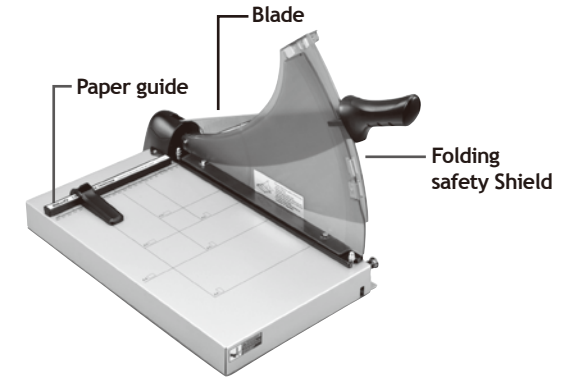

Performance

Specifications	A4, 12"	A3, 15"
Base size (W x D) in mm	445x282	545x382
Cutting length(mm)	360	460
Cutting capacity sheets(80 gsm)	40	40
Clamp	Auto	Auto
Safety shield	ABS shield	ABS shield
Blade lock	V	V
Measuring scale	MM/INCH	MM/INCH
Format Indication	A6-A4, 12"	A6-A3, 15"

How to use

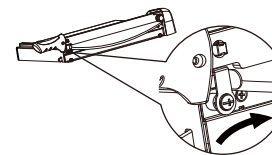

1. Hold the handle and release the blade lock carefully.

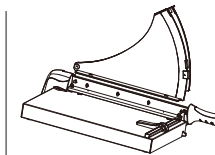

2. Quick release design to help you to install the folding safety shield on the clamping bar in place in few seconds.

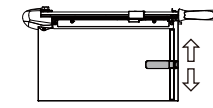

3. Adjust the paper guide to proper position.

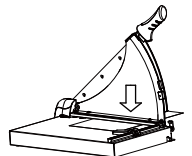

4. The stack of paper will be clamped automatically and firmly when you push down the handle.

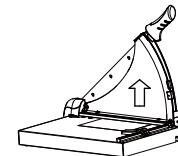

5. The safety shield will come up along with the handle while you raise the handle to its top position. The handle won't drop down unless you pull it down.

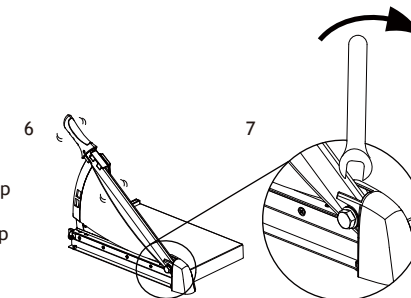

6. If you notice the handle is easily dropping down when you raise the handle to the top position.

7. Take out the plastic cap and use wrench to tighten the screws on both sides to make sure the handle won't fall down easily.

SAVE THESE INSTRUCTIONS FOR FUTURE REFERENCE